

A
SIZE

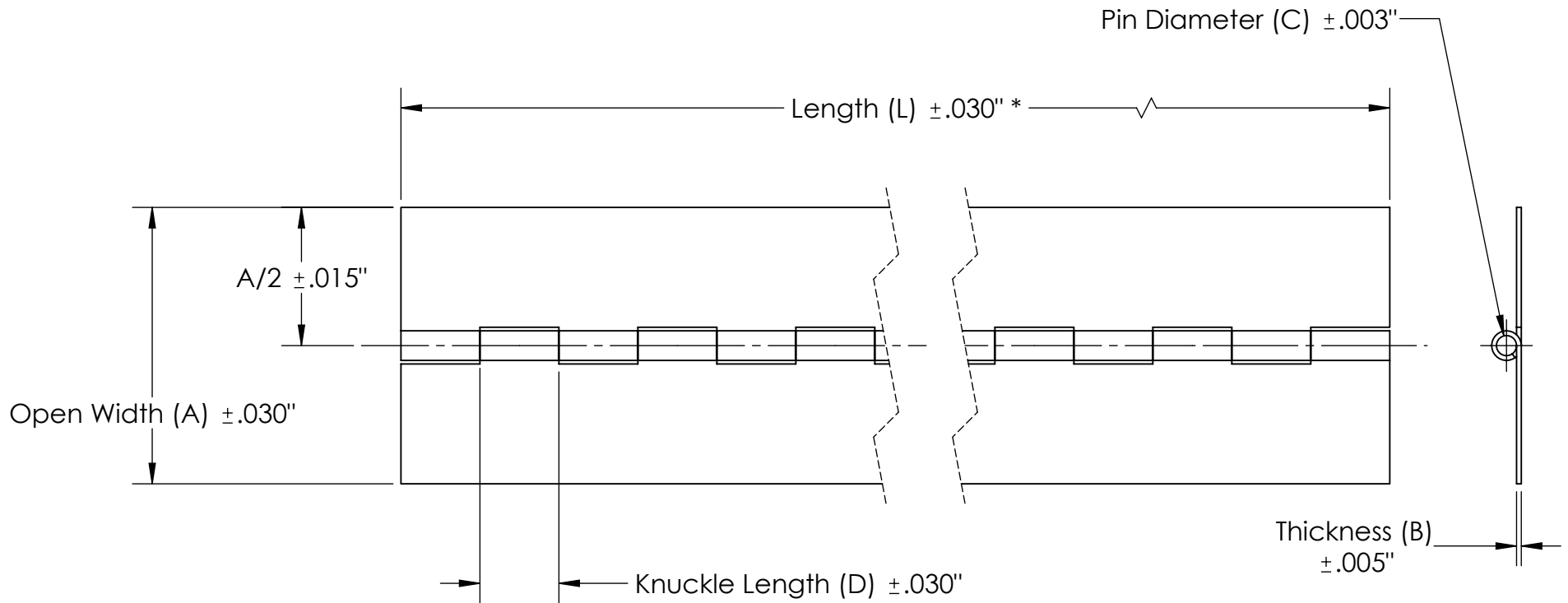
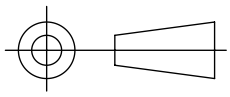

NOTES:

1. Range of Motion is Approximately 270°
2. Hinge Pin is Removable with Force
3. Acceptable Burr $\pm 10\%$ of material thickness
4. *Tolerance on length is $\pm .060''$ for hinges with thickness (B) $> .090''$

Part No.

Steel Piano Hinges (Various)

MATERIAL

Cold Rolled Steel

FINISH

None

Tolerances shown are unless otherwise specified. All tolerances are non-cumulative. All dimensions apply before any finish is applied.



ladeau.com | info@ladeau.com
ph. 818-240-3990 | fx. 818-240-1219

637 W. Colorado St.,
Glendale, CA 91204 USA

Part Number	Material	Thickness (B) (±.005 in/±.127mm)		Open Width (A) (±.030 in/±.762mm)		Knuckle Length (D) (±.030 in/±.762mm)		Pin Diameter (C) (±.003 in/±.076mm)		Stock Length (L) (±.030 in/±.762mm)	
S06250037S20-7200	Cold Rolled Steel	0.062 in	1.57 mm	5.000 in	127.00 mm	2.000 in	50.80 mm	0.375 in	9.53 mm	72 in	1828.8 mm
S06260037S20-7200	Cold Rolled Steel	0.062 in	1.57 mm	6.000 in	152.40 mm	2.000 in	50.80 mm	0.375 in	9.53 mm	72 in	1828.8 mm
S07520018S20-7200	Cold Rolled Steel	0.075 in	1.91 mm	2.000 in	50.80 mm	2.000 in	50.80 mm	0.186 in	4.72 mm	72 in	1828.8 mm
S07525018S20-7200	Cold Rolled Steel	0.075 in	1.91 mm	2.500 in	63.50 mm	2.000 in	50.80 mm	0.186 in	4.72 mm	72 in	1828.8 mm
S07530018S20-7200	Cold Rolled Steel	0.075 in	1.91 mm	3.000 in	76.20 mm	2.000 in	50.80 mm	0.186 in	4.72 mm	72 in	1828.8 mm
S07535018S20-7200	Cold Rolled Steel	0.075 in	1.91 mm	3.500 in	88.90 mm	2.000 in	50.80 mm	0.186 in	4.72 mm	72 in	1828.8 mm
S07540018S20-7200	Cold Rolled Steel	0.075 in	1.91 mm	4.000 in	101.60 mm	2.000 in	50.80 mm	0.186 in	4.72 mm	72 in	1828.8 mm
S07520025S20-7200	Cold Rolled Steel	0.075 in	1.91 mm	2.000 in	50.80 mm	2.000 in	50.80 mm	0.250 in	6.35 mm	72 in	1828.8 mm
S07525025S20-7200	Cold Rolled Steel	0.075 in	1.91 mm	2.500 in	63.50 mm	2.000 in	50.80 mm	0.250 in	6.35 mm	72 in	1828.8 mm
S07530025S20-7200	Cold Rolled Steel	0.075 in	1.91 mm	3.000 in	76.20 mm	2.000 in	50.80 mm	0.250 in	6.35 mm	72 in	1828.8 mm
S07535025S20-7200	Cold Rolled Steel	0.075 in	1.91 mm	3.500 in	88.90 mm	2.000 in	50.80 mm	0.250 in	6.35 mm	72 in	1828.8 mm
S07540025S20-7200	Cold Rolled Steel	0.075 in	1.91 mm	4.000 in	101.60 mm	2.000 in	50.80 mm	0.250 in	6.35 mm	72 in	1828.8 mm
S07550025S20-7200	Cold Rolled Steel	0.075 in	1.91 mm	5.000 in	127.00 mm	2.000 in	50.80 mm	0.250 in	6.35 mm	72 in	1828.8 mm
S07560025S20-7200	Cold Rolled Steel	0.075 in	1.91 mm	6.000 in	152.40 mm	2.000 in	50.80 mm	0.250 in	6.35 mm	72 in	1828.8 mm
S07520031S20-7200	Cold Rolled Steel	0.075 in	1.91 mm	2.000 in	50.80 mm	2.000 in	50.80 mm	0.312 in	7.92 mm	72 in	1828.8 mm
S07525031S20-7200	Cold Rolled Steel	0.075 in	1.91 mm	2.500 in	63.50 mm	2.000 in	50.80 mm	0.312 in	7.92 mm	72 in	1828.8 mm
S07530031S20-7200	Cold Rolled Steel	0.075 in	1.91 mm	3.000 in	76.20 mm	2.000 in	50.80 mm	0.312 in	7.92 mm	72 in	1828.8 mm
S07540031S20-7200	Cold Rolled Steel	0.075 in	1.91 mm	4.000 in	101.60 mm	2.000 in	50.80 mm	0.312 in	7.92 mm	72 in	1828.8 mm
S07550031S20-7200	Cold Rolled Steel	0.075 in	1.91 mm	5.000 in	127.00 mm	2.000 in	50.80 mm	0.312 in	7.92 mm	72 in	1828.8 mm
S07525037S20-7200	Cold Rolled Steel	0.075 in	1.91 mm	2.500 in	63.50 mm	2.000 in	50.80 mm	0.375 in	9.53 mm	72 in	1828.8 mm
S07530037S20-7200	Cold Rolled Steel	0.075 in	1.91 mm	3.000 in	76.20 mm	2.000 in	50.80 mm	0.375 in	9.53 mm	72 in	1828.8 mm
S07540037S20-7200	Cold Rolled Steel	0.075 in	1.91 mm	4.000 in	101.60 mm	2.000 in	50.80 mm	0.375 in	9.53 mm	72 in	1828.8 mm
S07550037S20-7200	Cold Rolled Steel	0.075 in	1.91 mm	5.000 in	127.00 mm	2.000 in	50.80 mm	0.375 in	9.53 mm	72 in	1828.8 mm
S09030025S20-7200	Cold Rolled Steel	0.090 in	2.29 mm	3.000 in	76.20 mm	2.000 in	50.80 mm	0.250 in	6.35 mm	72 in	1828.8 mm
S09035025S20-7200	Cold Rolled Steel	0.090 in	2.29 mm	3.500 in	88.90 mm	2.000 in	50.80 mm	0.250 in	6.35 mm	72 in	1828.8 mm
S09040025S20-7200	Cold Rolled Steel	0.090 in	2.29 mm	4.000 in	101.60 mm	2.000 in	50.80 mm	0.250 in	6.35 mm	72 in	1828.8 mm
S09050025S20-7200	Cold Rolled Steel	0.090 in	2.29 mm	5.000 in	127.00 mm	2.000 in	50.80 mm	0.250 in	6.35 mm	72 in	1828.8 mm
S09040031S20-7200	Cold Rolled Steel	0.090 in	2.29 mm	4.000 in	101.60 mm	2.000 in	50.80 mm	0.312 in	7.92 mm	72 in	1828.8 mm
S09050031S20-7200	Cold Rolled Steel	0.090 in	2.29 mm	5.000 in	127.00 mm	2.000 in	50.80 mm	0.312 in	7.92 mm	72 in	1828.8 mm
S09060031S20-7200	Cold Rolled Steel	0.090 in	2.29 mm	6.000 in	152.40 mm	2.000 in	50.80 mm	0.312 in	7.92 mm	72 in	1828.8 mm
S09040037S20-7200	Cold Rolled Steel	0.090 in	2.29 mm	4.000 in	101.60 mm	2.000 in	50.80 mm	0.375 in	9.53 mm	72 in	1828.8 mm
S09050037S20-7200	Cold Rolled Steel	0.090 in	2.29 mm	5.000 in	127.00 mm	2.000 in	50.80 mm	0.375 in	9.53 mm	72 in	1828.8 mm
S09060037S20-7200	Cold Rolled Steel	0.090 in	2.29 mm	6.000 in	152.40 mm	2.000 in	50.80 mm	0.375 in	9.53 mm	72 in	1828.8 mm
S12540031S20-7200	Cold Rolled Steel	0.125 in	3.18 mm	4.000 in	101.60 mm	2.000 in	50.80 mm	0.312 in	7.92 mm	72 ±.060 in	1828.8 ±1.52 mm
S12550031S20-7200	Cold Rolled Steel	0.125 in	3.18 mm	5.000 in	127.00 mm	2.000 in	50.80 mm	0.312 in	7.92 mm	72 ±.060 in	1828.8 ±1.52 mm
S12540037S20-7200	Cold Rolled Steel	0.125 in	3.18 mm	4.000 in	101.60 mm	2.000 in	50.80 mm	0.375 in	9.53 mm	72 ±.060 in	1828.8 ±1.52 mm
S12550037S20-7200	Cold Rolled Steel	0.125 in	3.18 mm	5.000 in	127.00 mm	2.000 in	50.80 mm	0.375 in	9.53 mm	72 ±.060 in	1828.8 ±1.52 mm
S12560037S20-7200	Cold Rolled Steel	0.125 in	3.18 mm	6.000 in	152.40 mm	2.000 in	50.80 mm	0.375 in	9.53 mm	72 ±.060 in	1828.8 ±1.52 mm